

Enclosure Boxes

E-Kabin O Series

E-Kabin O Series Enclosures from EAE Elektrotechnik are designed for general indoor electrical applications.



Product information:

- Protection class: IP 66
- Mounting plate included
- Paint: Epoxy - polyester powder paint. Colour: Standard RAL 7035
- Operating temperature: -5°C, +40°C
- Operating relative humidity: +20°C at %90, +40°C at %50
- Operating environment conditions: IE32 for %90 humidity & minimum -5°C
- Standards: IEC 61439-1, IEC 62208, IEC 60529, IEC 62262



Easy Mounting Bracket

Wall mounting can be easily done with the bracket set.



Support Profiles

Providing fixing surface for cables and other accessories and increase the strength of the door.



Standard Door Opening 125°

The door can be open 125° with the standard hinge set, providing full access during installation.



180° Hinge Accessory

The door can be open 180° with the optional hinge set.



Polyurethane Gasket

Behind the door to prevent loss of flexibility and adhesiveness with the effect of the time and protect against dust and water.

Lock Types

Different lock types are optionally selectable.



EG KT 11
Quarter Turn
Lock Set
-Standard-



EG KT 07
Wing Knob
with Key
Lock Set

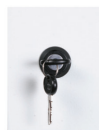

EG KT 12
Cylinder
Quarter-Turn
Lock Set



EG KT 13
Pad
Lockable
Lock Set



EG KT 14
Plastic Wing
Knob Lock
Set

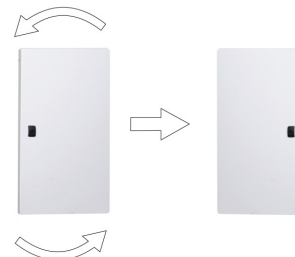

Bidirectional Door Opening

Door opening direction can be changed if needed.



E-KABIN O SERIES

Part Number	Description	Pack Qty
EO302015	EAE O Series Monoblock Enclosure. IP66 300x200x150mm	1
EO303015	EAE O Series Monoblock Enclosure. IP66 300x300x150mm	1
EO403015	EAE O Series Monoblock Enclosure. IP66 400x300x150mm	1
EO403020	EAE O Series Monoblock Enclosure. IP66 400x300x200mm	1
EO404020	EAE O Series Monoblock Enclosure. IP66 400x400x200mm	1
EO504020	EAE O Series Monoblock Enclosure. IP66 500x400x200mm	1
EO604020	EAE O Series Monoblock Enclosure. IP66 600x400x200mm	1
EO606030	EAE O Series Monoblock Enclosure. IP66 600x600x300mm	1
EO705020	EAE O Series Monoblock Enclosure. IP66 700x500x200mm	1
EO806020	EAE O Series Monoblock Enclosure. IP66 800x600x200mm	1
EO806030	EAE O Series Monoblock Enclosure. IP66 800x600x300mm	1
EO1006025	EAE O Series Monoblock Enclosure. IP66 1000x600x250mm	1

Find out more, visit www.coreelectrical.com

Power in Progress



Contact us to get a quote or seek advice about the best solution for your project.

Core in N.Ireland (Belfast)

T. +44 (0)28 9002 0066

E. info@coreelectrical.com

Core in Ireland (Dublin)

T. +353 (0)1 453 7033

E. info@coreelectrical.ie